

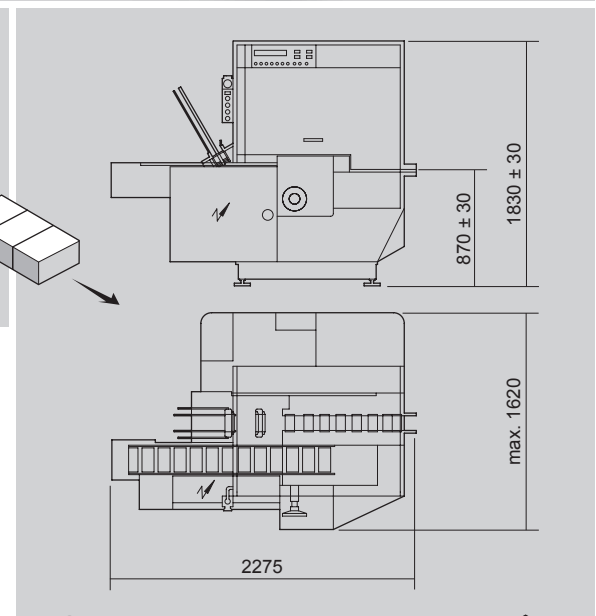

PMM

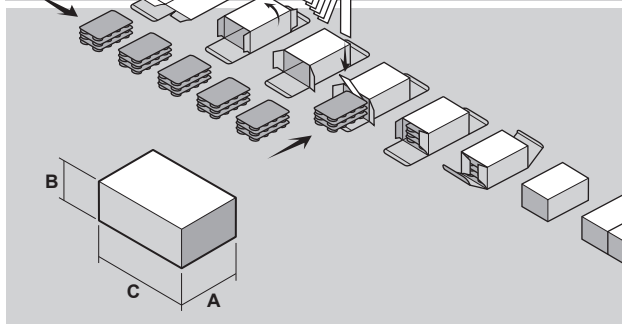

Intermittent motion horizontal cartoner



TECHNICAL DATA

Mechanical speed	STROKES/1'	25+140
Motors	KW	0.92
Power absorption	KW	1.55 (Hot-melt + 3.9)
Air consumption	NI/1'	16.9
Air pressure	bar	5+6
Gross weight	kg	~1400
Net weight	kg	~1050
Size range	min.	max.
A	15	90
B	12	70
C	50	200
A + B	-	140

The above technical data are not binding and may be subject to change without prior notice.

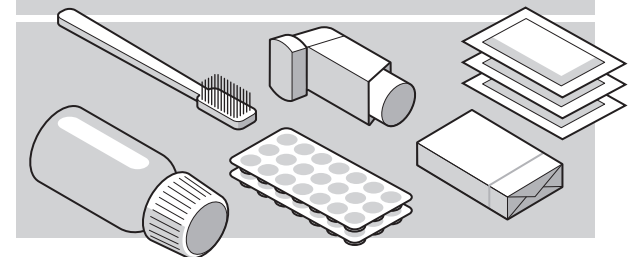

CM-008-uk (12/11/2014)
Extr. from FM-PMM-02-uk (10/11/2014)

This publication supersedes and replaces any previous edition and revision. All rights reserved. No part of this publication may be reproduced, stored in a retrieval system or transmitted in any form or by any means, electronic, mechanical, photocopying, recording or otherwise, without permission of Tecnicam s.r.l. (Bologna - Italy).